



Instructions
Gebrauchsanleitung
Instrucciones
Istruizione

FLEXI **TESTER**
FTX100

Chlorine HR
(0.0 - 5.0 mg/l)

pH (6.5 - 8.4)



WATER TESTING
MADE IN GERMANY

Reagents
Reagenzien
Réactifs
Reactivos
Reagenti



FTX100

TbsRD1
DPD 1 RAPID (free chlorine)

TbsRpH
Phenol Red RAPID (pH)

Refill-Pack:

TbsRD1pH60
30 x Phenol Red RAPID
30 x DPD 1 RAPID

Optional
TbsRD3
50 x DPD 3 RAPID
not included in basic kit

WATER TESTING
MADE IN GERMANY

(GB) CAUTION!

Reagents for water-analysis only!
Do not eat! Keep away from children!
Store cool and dry!
Clean tester properly before testing!

(F) Attention!

Les pastilles sont exclusivement destinées aux analyses chimiques. NE PAS AVALER. Tenir hors de portée des enfants. Conserver dans un endroit frais et sec. Bien rincer le testeur avant chaque utilisation!

(E) ¡Atención!

Pastillas para el análisis de aguas, solamente para análisis químicos!
No para tomar!
No debe llegar a las manos de niños!
Consérvese en lugar fresco y seco!
Limpiar el aparato antes de usar!

(I) Attenzione!

Reagenti unicamente per analisi acqua!
Non ingerire!
Tenere fuori dalla portata dei bambini!
Mantenere in luogo asciutto e fresco
Dopo l'utilizzo pulire ed asciugare accuratamente il tester.

(DE) Achtung!

Reagenzien nur für chemische Analysen!
Nicht einnehmen! Darf nicht in die Hände von Kindern gelangen! Kühl und trocken lagern!



1

Fill with 10ml of water to be tested



2a

Chlorine



1 x

Free Chl. = 1 x DPD 1

Total Chl. = 1 x DPD 1 + 1 x DPD 3
plus 2 Min.

Combined Chl. = Total Chl. - Free Chl.

2b

pH

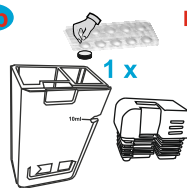

1 x

pH = 1 x Phenol Red Rapid

3a

3b

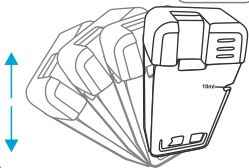

4a

4b

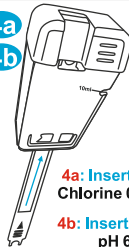

4a: Insert FTS101 stick
Chlorine 0.00 - 5.00 mg/l

4b: Insert FTS50 stick
pH 6.5 - 8.4

5a

5b

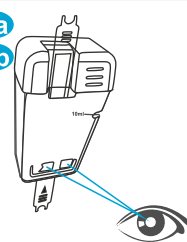

!!! Important !!!

Very high chlorine levels will bleach out the DPD reagent and lead to colorless solution!

DPD RAPID tablets leave a white residue on the bottom of the tester. This is normal and does not interfere with the measurement

no detergent!



clean properly

